

OSWELL + NITSHIN

ARCHITECTURE  
LAND DEVELOPMENT

1234 POWERS PERRY COMMONS  
SUITE 105  
MARIETTA, GEORGIA 30067  
770 956-8879 TELEPHONE  
770 956-8931 FACSIMILE

THIS DRAWING IS AN INSTRUMENT OF  
SERVICE AND REMAINS THE PROPERTY OF  
OSWELL AND NITSHIN ARCHITECTS, P.C.



**AUTO PARTS**  
GENUINE PARTS COMPANY  
222 CHASTAIN MEADOWS COURT  
SUITE 200  
KENNESAW, GA 30144

**HARRIS COUNTY, TEXAS**  
VETERANS MEMORIAL PARKWAY &  
NORTH CAMDEN PARKWAY

- ORIGINAL ISSUE DATE: 07/15/05  
REVISIONS
- 07/25/05 JOINT ACCESS
  - 09/20/05 SURVEY, FLAP BUILDING
  - 10/04/05 ELIMINATE DRIVE
  - 10/10/05 BACK TO SCH. 2 NEW DRIV.
  -

SITE PLAN

Project Number 2005076

**SP-1**

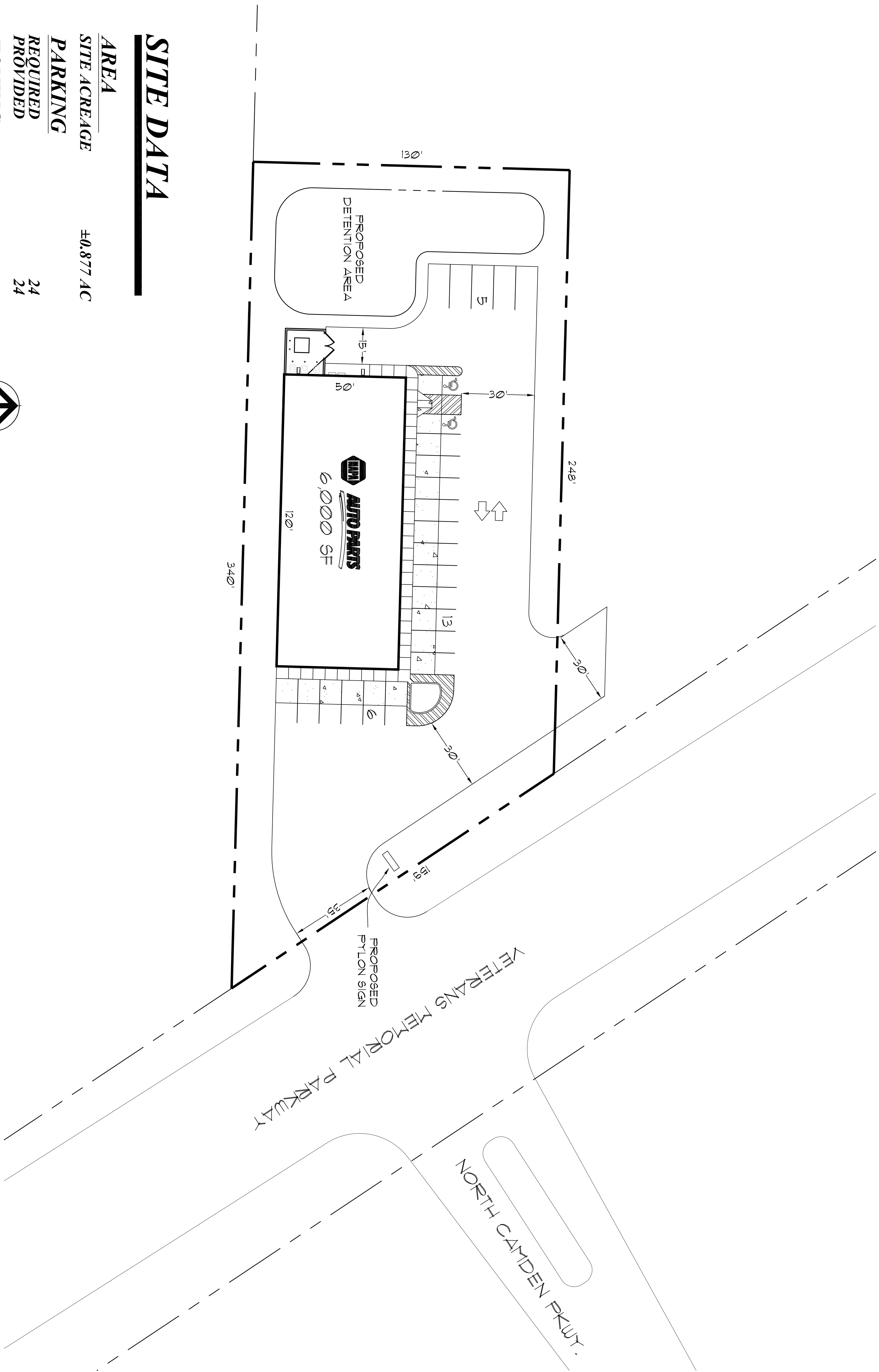

**SITE DATA**

<b>AREA</b>	
<b>SITE ACREAGE</b>	±0.877 AC
<b>PARKING</b>	
<b>REQUIRED PROVIDED</b>	24
<b>ZONING</b>	24
<b>EXISTING ZONING</b>	N/A